

LLAS7 Photo Controls

LLAS7-1, LLAS7-2

Thermal photo control

- ⊙ Rated voltage: 120V/220V/~/ (applicable 110V,127V,230V,240V)
- ⊙ Rated frequency: 50/60Hz
- ⊙ Rated current: 10A 15A
- ⊙ Load: 1000W,2000W TUNGSTEN
- ⊙ Light level: on/off; 10-16LUX/50-80LUX
- ⊙ Acting time: 30" ~180"
- ⊙ Temperature range: -40°C ~ +70°C
- ⊙ Electrical life: >6500CYCLES

Electromagnetic Photo Control

- ⊙ Rated voltage: 120/240V/~/ (applicable 105-240V~)
- ⊙ Rated frequency: 50/60Hz
- ⊙ Rated current: 10A 15A
- ⊙ Load: 1000W,2000W TUNGSTEN
- ⊙ Light level: ON/OFF;10-16LUX/20-30LUX or at customers'option
- ⊙ Acting time: <15"
- ⊙ Temperature range: -40°C ~ +70°C
- ⊙ Electrical life: >6500CYCLES

- ⊙ Electronic Photo Control
- ⊙ Rated voltage: 120/240V/~/ (applicable 105-305V~)
- ⊙ Rated frequency: 50/60Hz
- ⊙ Rated current: 10A 15A
- ⊙ Load: Load: 1000-2000W TUNGSTEN
- ⊙ Light level: ON/OFF;10-16LUX/20-30LUX or at customers'option
- ⊙ Acting time: <15"
- ⊙ Temperature range: -40°C ~ +70°C
- ⊙ Electrical life: >6000CYCLES

LLAS7-3

Thermal photo control

- ⊙ Rated voltage: 120V/220V/~/ (applicable 110V,127V,230V,240V)
- ⊙ Rated frequency: 50/60Hz
- ⊙ Rated current: 10A 15A
- ⊙ Load: 1000W,2000W TUNGSTEN
- ⊙ Light level: on/off; 10-16LUX/50-80LUX
- ⊙ Acting time: 30" ~180"
- ⊙ Temperature range: -40°C ~ +70°C
- ⊙ Electrical life : >6500CYCLES

Exterior dimension(mm)
LLAS7-1 LLAS7-2

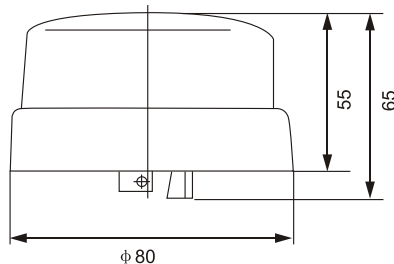

LLAS7-1 10A



LLAS7-2 10A

Exterior dimension(mm)

LLAS7-3

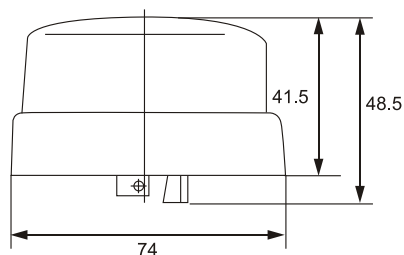

LLAS7-3 10A